

A1

DO NOT SCALE

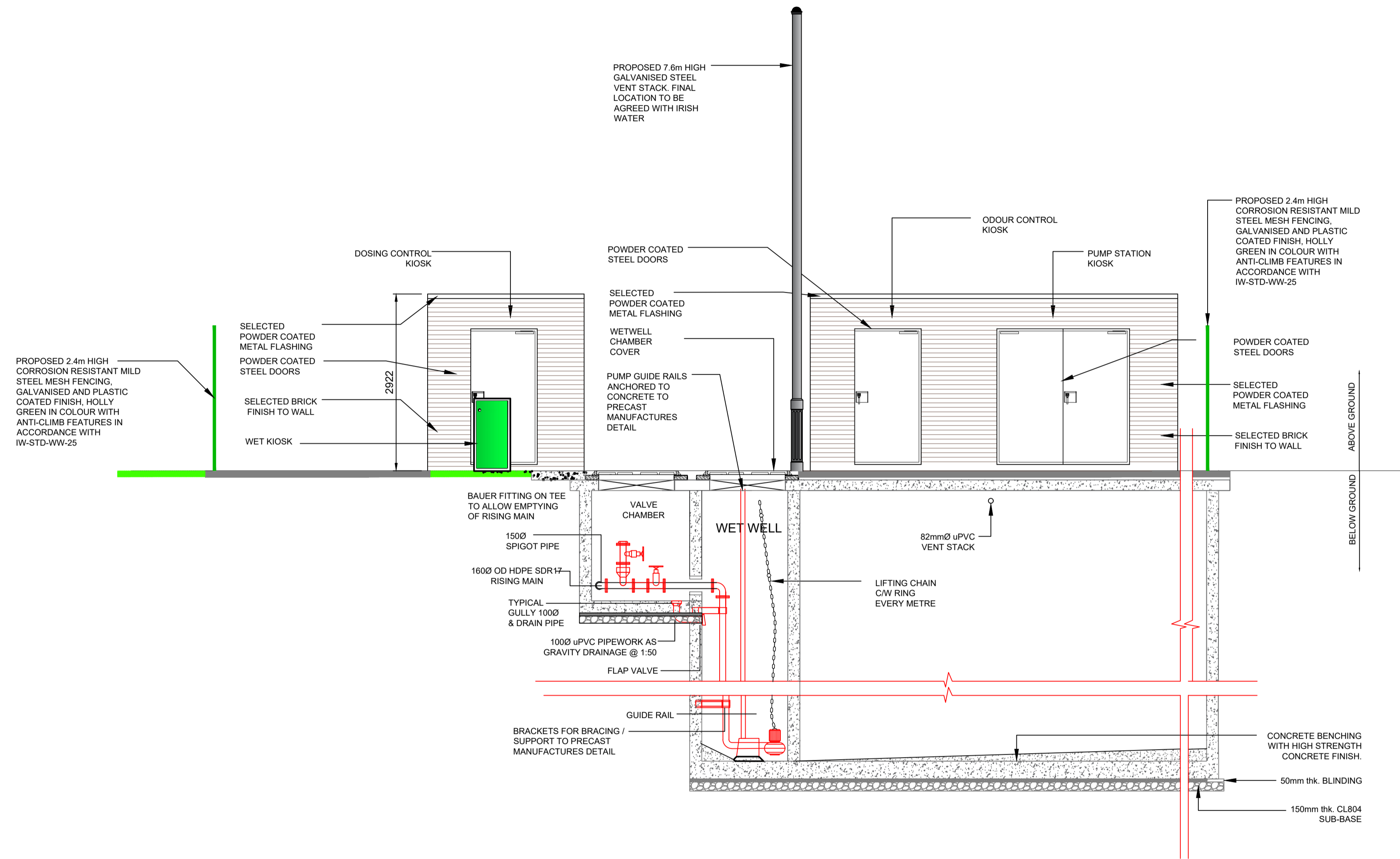

SECTION A
FOUL PUMPING STATION AND 24
HOUR EMERGENCY STORAGE TANK
(732m3) - INTERIM SOLUTION

File: 5154251_LWC_DR_0535-0537.dwg
Date: Oct 31, 2019 - 12:10pm
Plotted by: patrick.sheridan

© ORDNANCE SURVEY IRELAND LICENSE No. AR 0082518
ORDNANCE SURVEY IRELAND & GOVERNMENT OF IRELAND

Rev	Description	By	Date	Chk'd	Auth
A	FOR PLANNING	PS	18.10.19	AC	GH
A	FINAL CLIENT APPROVAL	PS	09.10.19	AC	GH
-	ISSUED FOR IW REVIEW	PS	08.08.19	AC	GH

ATKINS
Member of the SNC-Lavalin Group

Atkins House, 150-155 Airside
Business Park, Swords, Co. Dublin
Tel (+353) 01 810 8000
Fax (+353) 01 810 8001

Unit 2B, 2200 Cork Airport
Business Park, Cork
Tel (+353) 021 429 0300
Fax (+353) 021 429 0360

2nd Floor Technology House
Parkmore Technology Park, Galway
Tel (+353) 091 786 0550
Fax (+353) 091 779 830

Client	AEVAL		
Project	WOODBROOK PHASE 1		

Purpose	PLANNING						
Title	PROPOSED PUMP STATION SECTION						
Original Scale	1:50 at A1	Design/Drawn	PS	Checked	AC	Authorised	GH
Scale	1:100 at A3	Date	08.08.19	Date	08.08.19	Date	08.08.19
Status	P	Drawing Number	5154251 / EWE / DR / 0536		Rev	A	